

# 14" P-cap Touch Monitor

**Model** **H1412P-UH**

---

**Touch Technology** **P-cap**

---

**Version** **V 1.0**

---





## Open-frame Touch Monitor

Horsent designs H1412P-UH open-frame multi-touch monitor for high traffic vertical applications, such as finance, gaming, industry, self-service terminal, etc.

The H1412P-UH applies high performance PCAP touch technology, offers excellent 10-point touch and tablet-like user experience.

The durable, light weighted, display module delivers image with high resolution and clarity, yet still low power consumption.

The H1412P-UH features a special designed mounted-molded front bezel, enables perfect matched mounting to your kiosk with great dust&water resistance.



### Features

- 10-point touch
- Slim bezel
- Firm sealing
- Accurate touch
- Compact design
- Easy to install
- Flush mounted



### Applications

- ATM
- Tickets machine
- Vending machine
- Information terminal
- Gaming machine

Product Name		14 inch LCD Touch Monitor		
Product Model		H1412P-UH		
LCD panel Technical Parameter	Size	14inch		
	Aspect Ratio	16 : 9		
	Backlight Type	LED Backlight		
	Pixel Pitch	0.1611mm x 0.1611mm		
	Active Area	309.31mm x 173.99mm		
	Best Resolution	1920 × 1080 @ 60Hz		
	Response Time	25ms		
	Color	6-bit, 262,144 colors		
	Brightness	LCD Panel: 250 cd/m <sup>2</sup>		
	Contrast Ratio	700:1 (standard Value)		
	Viewing Angle (CR > 10)	Horizontal: 160° (80°/80°)    Vertical: 160° (80°/80°)		
	Video Input Format	RGB Analog Signal/ Digital Signal		
	Video Input Interface	VGA / HDMI		
	Input Frequency	Horizontal: 30~82 Hz    Vertical: 50~75 Hz		
	Power Consumption	≤8W		
Touch Screen Technical Parameter	Touch Screen Type	Capacitive Touch Screen		
	Gover Glass	2.4mm		
	Transparency	87%		
	Hardness	7H		
	Interface	USB2.0		
	Touch Point	10		
	Response Time	≤15ms		
	Touch Method	Finger / Capacitive Pen		
	Touch Lifespan	≥50,000,000		
	Linearity	< 2%		
	Single-point OS	Windows XP , Linux		
	Multi-point OS	Windows7/8/10 , Android		
Touch Monitor Technical Parameter	Boundary Dimension	339.2mm × 214mm × 38.9mm		
	OSD Panel	Optional Accessory : Power switch、 Menu、 Up、 Auto、 Down		
	Power Supply	Input : DC 12V±5%		
	Power Consumption	Max : 12w;    Sleep : 3w;    Off : 2w		
	Installation	Side Mounting Bracket , VESA 75mm&100mm		
	Accessory (Optional)	Signal Line	VGA ,    HDMI , 1.5m	
		USB Wire	A male to B male , 1.8m	
		Adaptor	WT1203000 , 12V/3.0A , 115mmx47mmx31mm , Lenqth 1.0m ,    ϕ 2.5 , Black	
		Power Line	CCC Power Line, 1.5m , Black	
	Temperature	Operating: 0°C-40°C ;    Storage: -20°C-60°C		
	Humidity	Operating: 20%-80%;    Storage: 10%-90%		
	Operation Altitude	< 3000m		
	Warranty	1 year		



# Product drawing

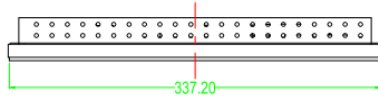

Top View

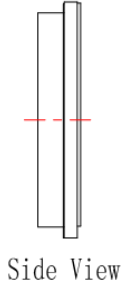

Side View

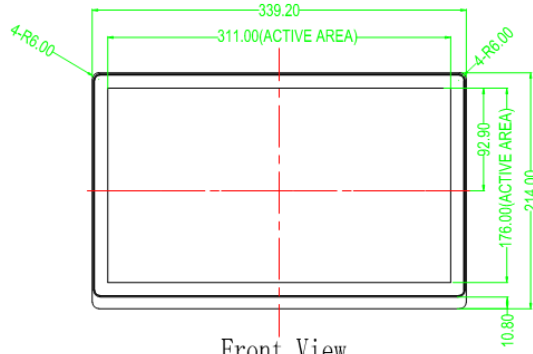

Front View

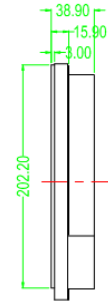

Side View

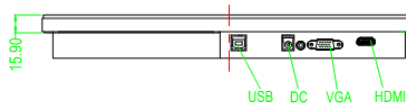

Bottom View

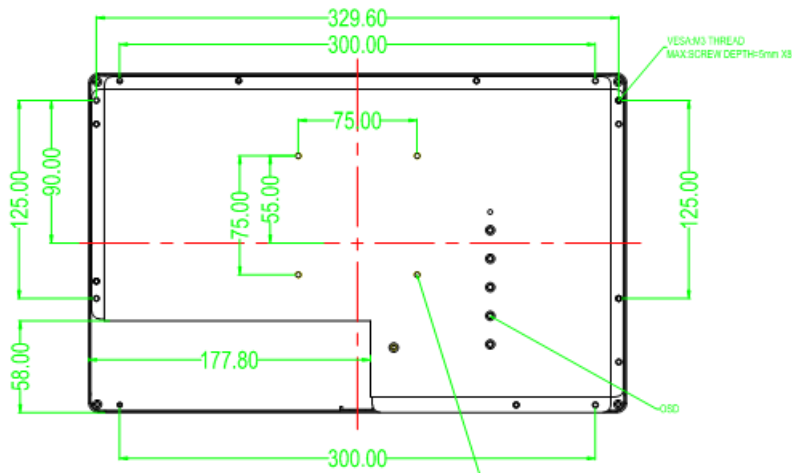

Back View

VESA:M4 THREAD  
MAX:SCREW DEPTH=5mm X4



All rights reserved, Horsent Technology Co., Ltd